

Recommended PCB Layout(Top Side)
(PCB BOARD TOLERANCE±0.05)

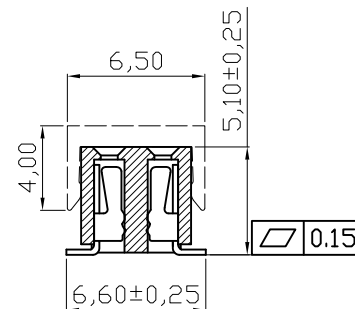
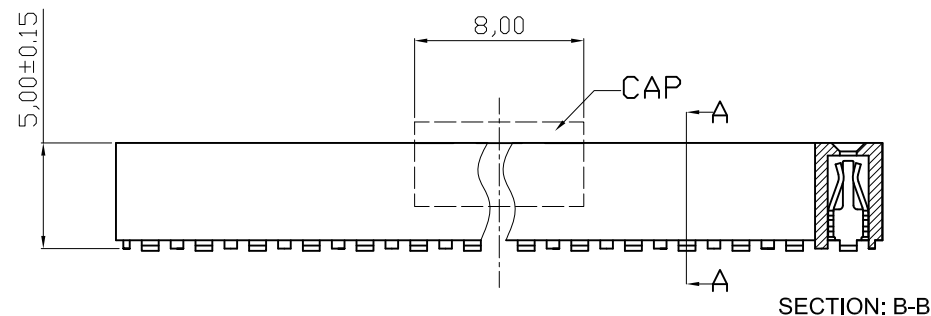
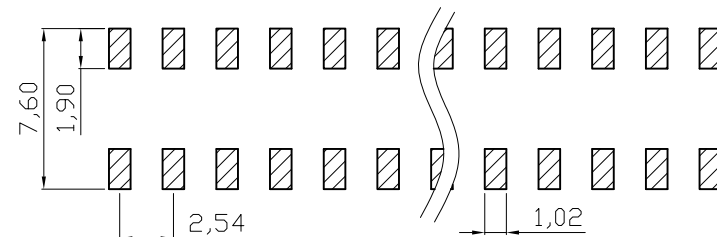

NOTES:

MATERIAL

- 1. Insulator Material: PA6T+30%GF(UL94V-0)
- 2. Contact Material : Phosphor Bronze
- 3. Contact Plating : 1u" Au over Ni

ELECTRICAL

- 1. Current Rating : 3.0AMP
- 2. Withstand Voltage : 500V AC/DC
- 3. Contact Resistance : 20mΩ max
- 4. Insulation Resistance: 1000MΩ min

ENVIRONMENTAL

- 1. Operation Temperature: -40°C to +105°C
- 2. Packing : Tube+CAP

RoHS compliant

Scale	1:1						Date	Name	Customer-No.
TOLERANCE						Drawn	05.05.2009	Dean	
X.X	±0.40					Approved	05.05.2009	Hellwig	ASSMANN WSW-No. A-BL254-DG-GxxMP1
X.XX	±0.25								Drawing-No.
X.XXX	±0.15								ASS 3505 CO
Angle	±3°								rev01
		①	Drawn	05.05.2009	Dean			Replace	Sheet
DIM	TOL	Id.	Modification	Date	Name				