

REV.	RIF.	DESCR. MODIFICA	DATA	AUTORE
1		Sostituito il prodotto da MTBH02008 a MTBH02008-0N	25-11-05	BORELLA
2		Ottimizzato il tape (era WIMTB24DT)	26-05-09	Biasio
3		Aggiunto note nel confezionamento	13-11-09	Biasio
4		Mod. quantità scatolone (da 7 a 9 bobine)	29-06-10	Biasio

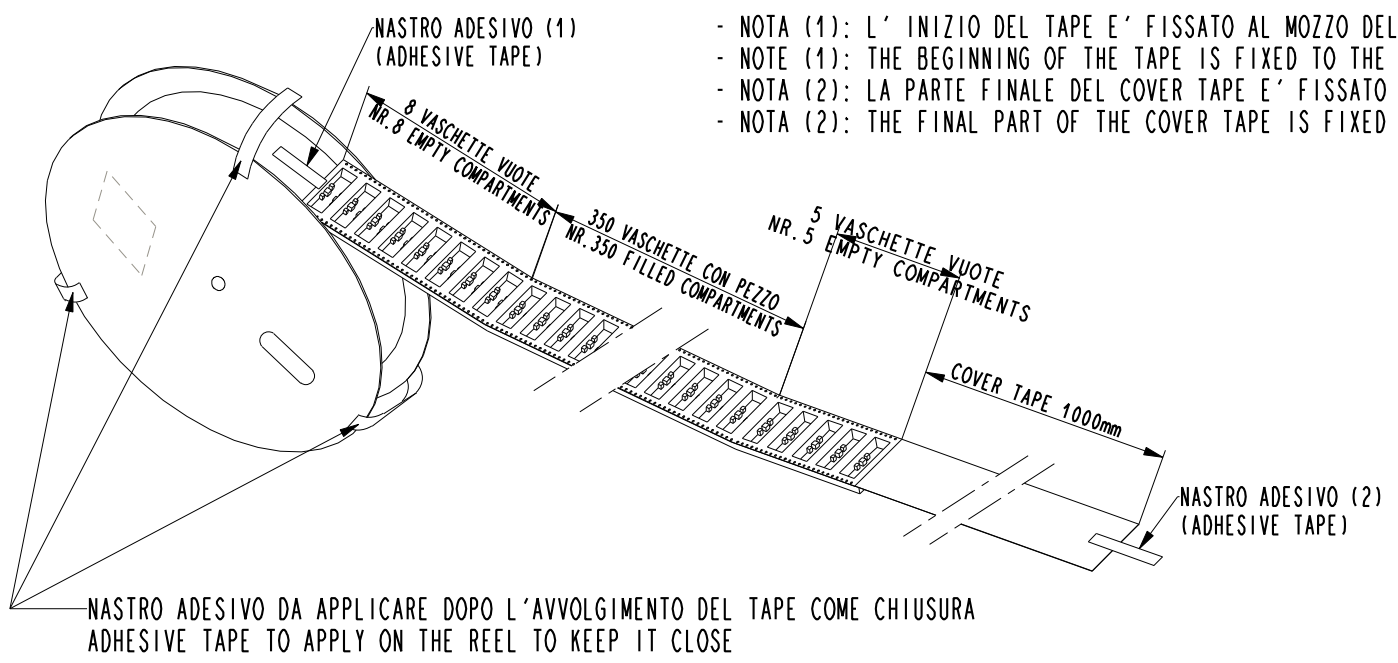

- NOTA (1): L' INIZIO DEL TAPE E' FISSATO AL MOZZO DELLA BOBINA CON NASTRO ADESIVO.
- NOTE (1): THE BEGINNING OF THE TAPE IS FIXED TO THE REEL WITH ADHESIVE TAPE.
- NOTA (2): LA PARTE FINALE DEL COVER TAPE E' FISSATO CON NASTRO ADESIVO AL TAPE AVVOLTO.
- NOTA (2): THE FINAL PART OF THE COVER TAPE IS FIXED BY ADHESIVE TAPE TO THE TAPE ON THE REEL.

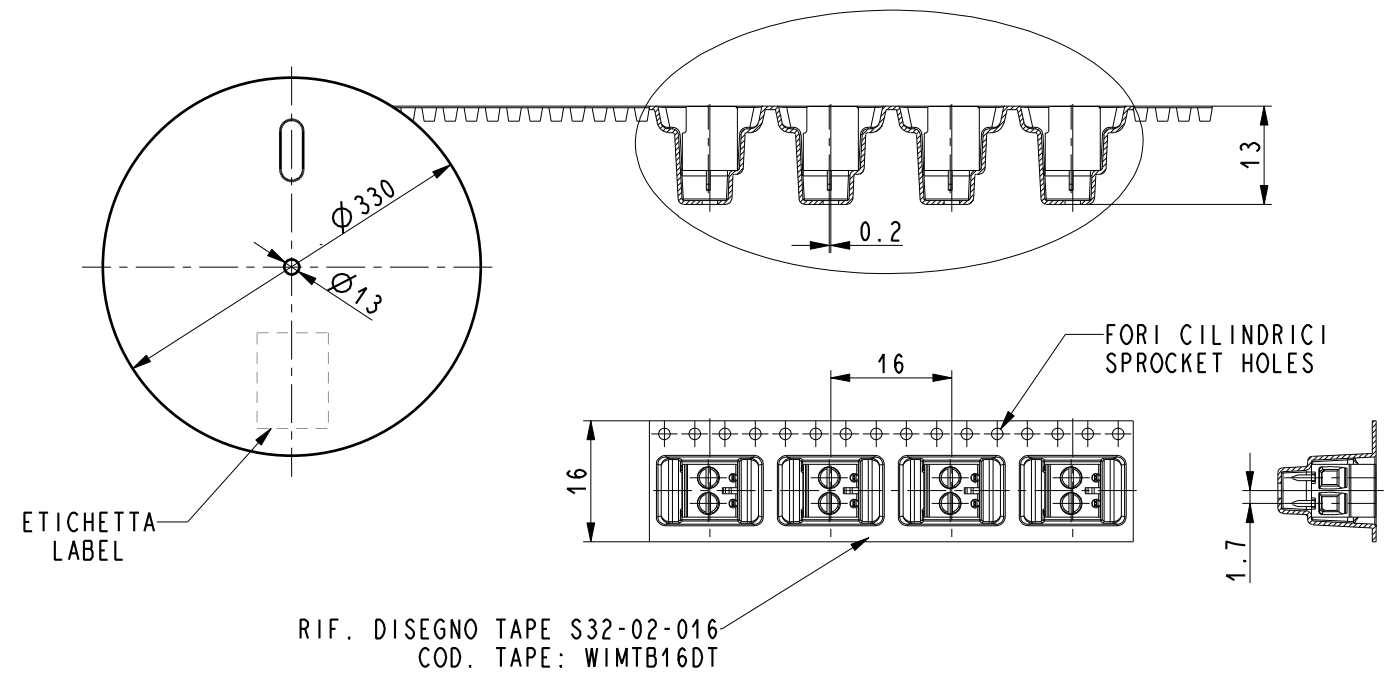

CONFEZIONAMENTO BOBINE MAX. N°9
(PACKAGING: MAX. NR.9 REELS/BOX)
-OGNI BOBINA E' INSERITA IN UN SACCHETTO W10118-NY SIGILLATO A CALDO
-USARE SCATOLONE W10081-TV
-INSERIRE IN OGNI SCATOLONE IL FOGLIO INFORMATIVO: V20-00-001

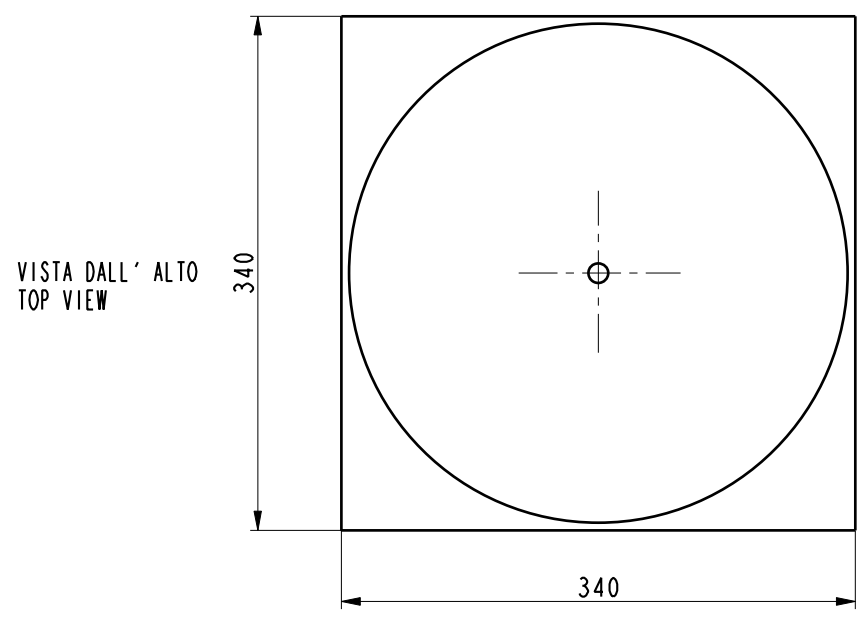
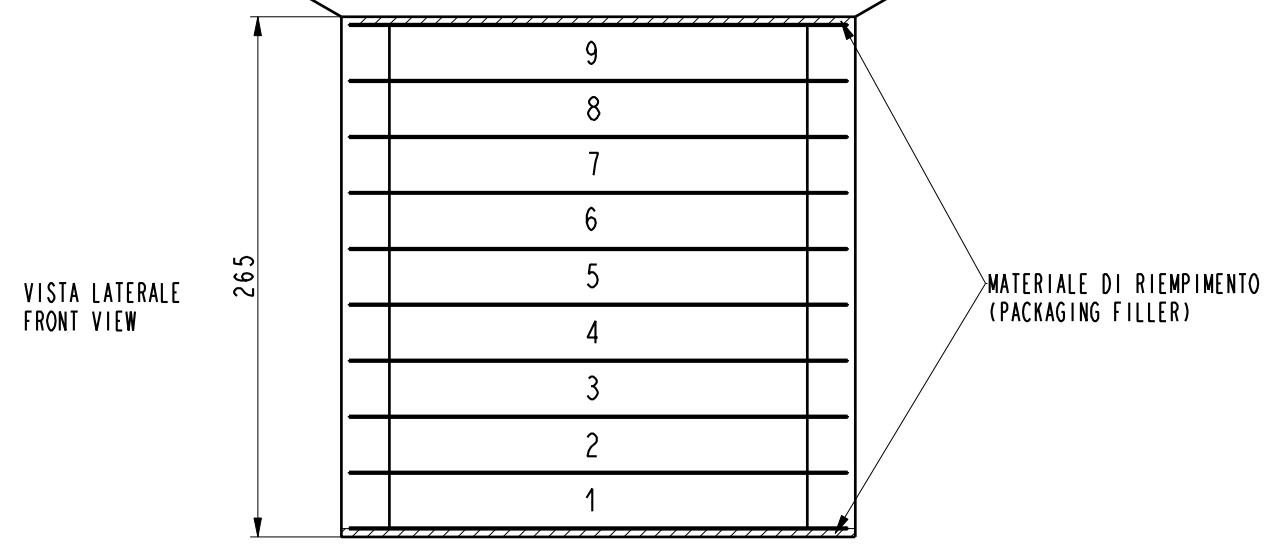

NOTE:
-BOBINA IN CARTONE Ø330 L=16
-350 PEZZI PER BOBINA
-CARTON REEL: D=330 W=16
-350 PCS/REEL

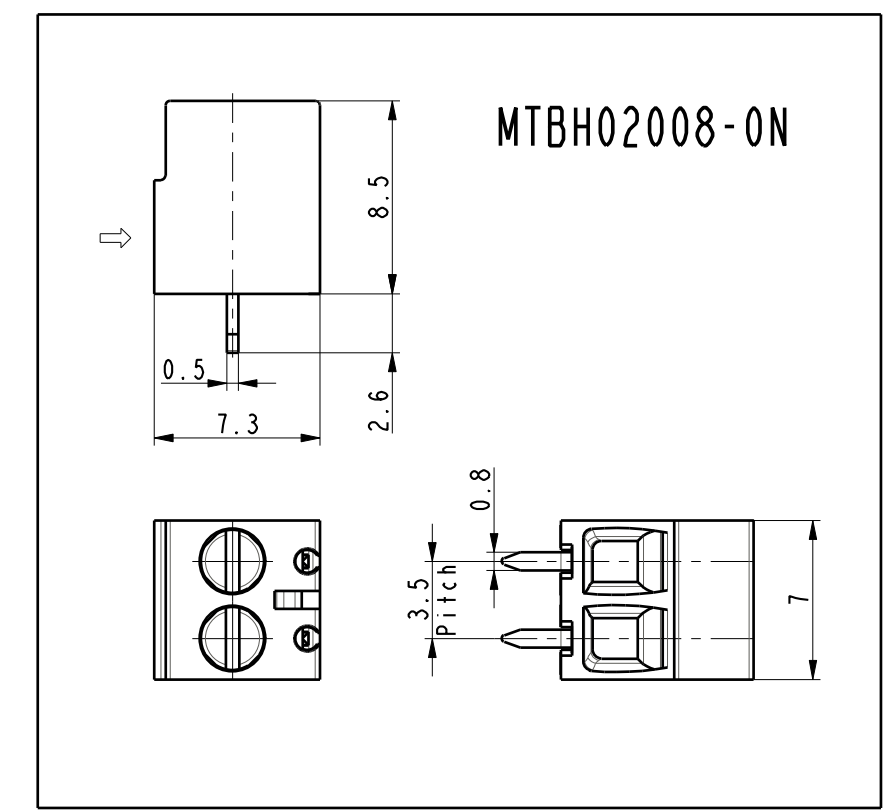

CODICE	KMTBH02008TN			
REVISIONE:	KIT:	PASSO/PITCH:		
-	KMTBH02008TN	-		
FOGLIO:	DIS.N°:	FIRMA:	DATA:	
1/1	KMTBH02008TN	Rampazzo	16-Sep-05	

