

3-phase Filters FN 351

General Purpose EMC Filter for Three-phase Applications

SCHAFFNER
energy efficiency and reliability



- EMC solution for industrial inverters and motor drives
- Rated currents from 8 to 280A
- Selectable voltage level of 440V and 520V
- High differential and common-mode attenuation
- Compliant with IEC 60950

Approvals

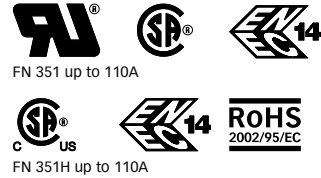

Technical specifications

Maximum continuous operating voltage:	3x 440/250VAC (FN 351) 3x 520/300VAC (FN 351H)
Operating frequency:	dc to 60Hz
Rated currents:	8 to 280A @ 40°C
High potential test voltage:	P → E 2600VDC for 2 sec (FN 351) P → P 1900VDC for 2 sec (FN 351) P → E 2750VDC for 2 sec (FN 351H) P → P 2250VDC for 2 sec (FN 351H)
Protection category:	IP20
Overload capability:	4x rated current at switch on, 1.5x rated current for 1 minute, once per hour
Temperature range (operation and storage):	-25°C to +85°C (25/085/21) (FN 351) -25°C to +100°C (25/100/21) (FN 351H)
Flammability corresponding to:	UL 94V-2 or better
Design corresponding to:	UL 1283, CSA 22.2 No. 8 1986, IEC/EN 60939
MTBF @ 40°C/400V (Mil-HB-217F):	135,000 hours

Typical electrical schematic

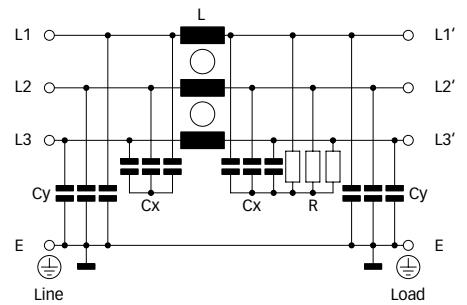

Features and benefits

- Broad range of power ratings for fast and convenient filter selection.
- Available as 440VAC (FN 351) and 520VAC (FN 351H) versions for network-specific applications.
- FN 351 filters provide a broadband common and differential-mode attenuation performance, which remains available also when high interference levels are present.
- Solid, touch-safe filter terminals contribute to overall equipment safety and make the filters compliant with IEC 60950.
- Introduced as one of the very first motor drive EMC filters in the market, FN 351 has been widely imitated and has successfully proven its function over more than 10 years.

Typical applications

- Three-phase motor drives
- Inverters and converters
- Industrial automation equipment
- UPS
- SMPS
- General purpose three-phase filtering

Filter selection table

Filter*	Rated current @ 40°C (25°C)	Typical drive power rating**	Leakage current*** @ 400VAC/50Hz	Power loss @ 25°C/50Hz	Input/Output connections	Weight [kg]
	[A]	[kW]	[mA]	[W]		
FN 351-8-29	8 (9.2)	3	1.9	7	-29	0.8
FN 351-16-29	16 (18.5)	5.5	1.9	8	-29	1.3
FN 351-25-33	25 (28.9)	11	28.0	8	-33	1.4
FN 351-36-33	36 (41.6)	15	28.0	9	-33	1.5
FN 351-50-..	50 (57.7)	22	29.5	11	-33 -34	1.6
FN 351-64-..	64 (73.9)	30	29.5	15	-33 -34	1.7
FN 351-80-34	80 (92.3)	37	31.8	23	-34	5.6
FN 351-110-35	110 (127)	55	31.8	25	-35	5.8
FN 351-180-36	180 (208)	90	29.6	49	-36	13.0
FN 351-280-37	280 (323)	132	35.7	70	-37	28.0
FN 351H-8-29	8 (9.2)	4	2.3	7	-29	1.1
FN 351H-16-29	16 (18.5)	7.5	2.3	8	-29	1.3
FN 351H-25-33	25 (28.9)	15	32.7	8	-33	1.4
FN 351H-36-33	36 (41.6)	18.5	32.7	9	-33	1.5
FN 351H-50-..	50 (57.7)	30	32.7	11	-33 -34	1.6
FN 351H-64-33	64 (73.9)	37	32.7	15	-33	1.7
FN 351H-80-34	80 (92.3)	45	38.0	23	-34	5.6
FN 351H-110-35	110 (127)	75	38.0	25	-35	5.8
FN 351H-180-36	180 (208)	110	35.6	49	-36	13.0
FN 351H-280-37	280 (323)	160	42.9	70	-37	28.0

* To compile a complete part number, please replace the .. with the required I/O connection style.

** Calculated at rated current, 400VAC (FN 351)/480VAC (FN 351H) and cos phi = 0.8. The exact value depends upon the efficiency of the drive, the motor and the entire application.

*** Maximum leakage under normal operating conditions (FN 351 at 400V, FN 351H at 480V). Note: if two phases are interrupted, worst case leakage could reach 6 times higher levels.

Typical filter attenuation

Per CISPR 17; A = 50Ω/50Ω sym; B = 50Ω/50Ω asym; C = 0.1Ω/100Ω sym; D = 100Ω/0.1Ω sym

8A types

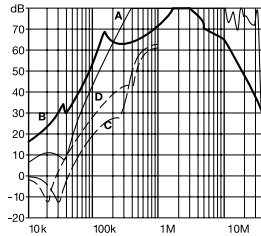

16A types

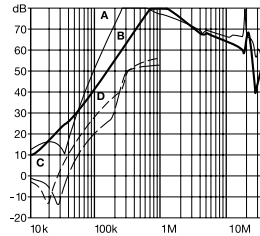

25A types

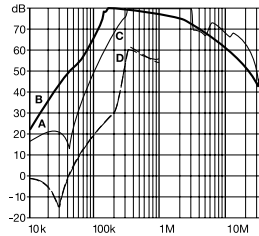

36 and 50A types

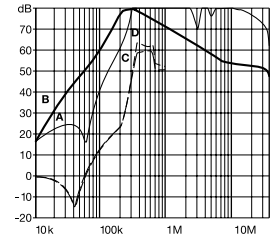

64A types

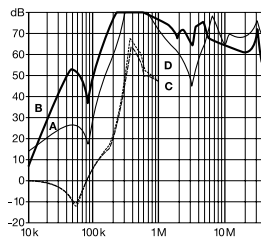

80 and 110A types

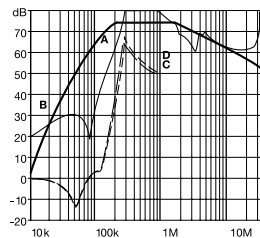

180A types

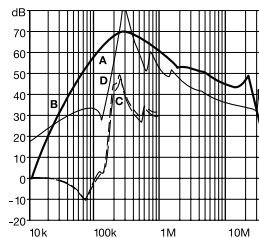

280A types

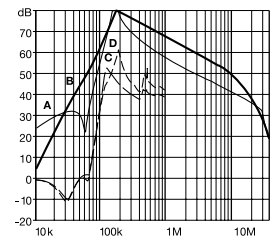

Mechanical data

8 and 16A types

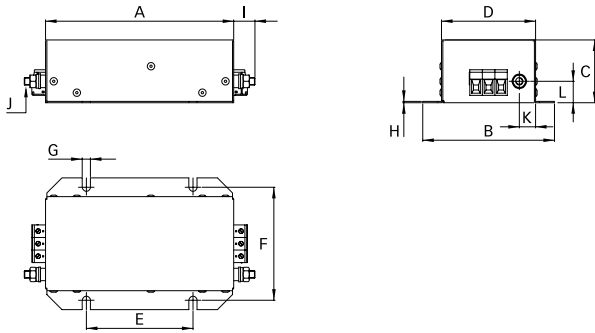

25 to 64A types

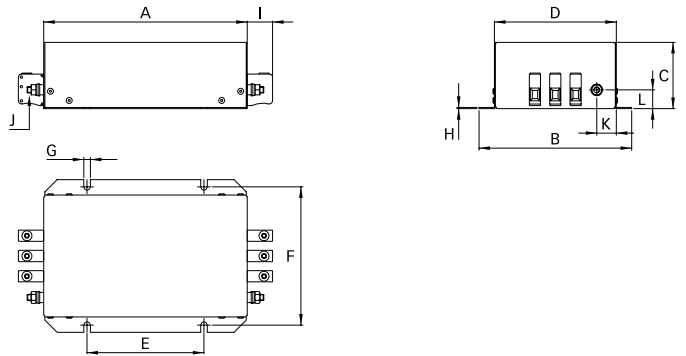

80 and 110A types

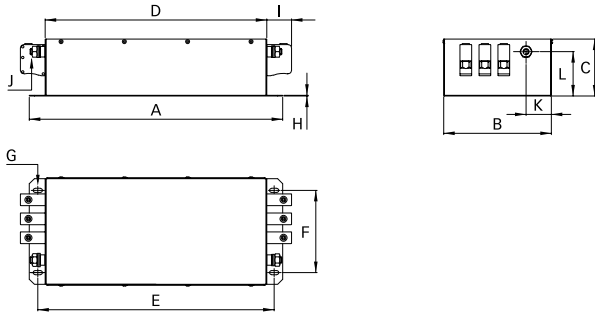

180 and 280A types

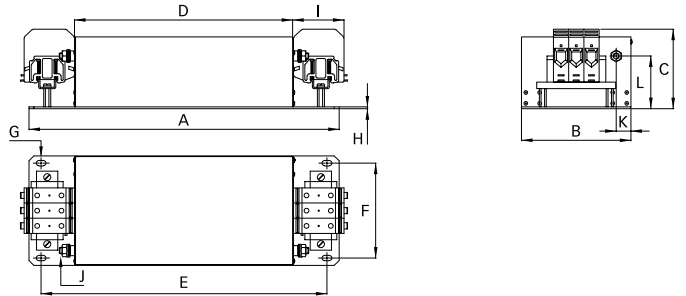

Dimensions

	8A	8A (-H)	16A	25A	36A	50A (-33)	50A (-34)	64A (-33)	64A (-34)	80A	110A	180A	280A
A	180	200	200	200	200	200	200	200	200	400	400	510	700
B	115	150	150	150	150	150	150	150	150	170	170	180	260
C	60	65	65	65	65	65	80	65	80	90	90	130	155
D	85	120	120	120	120	120	120	120	120	350	350	360	530
E	115	115	115	115	115	115	115	115	115	373	373	470	660
F	100	136	136	136	136	136	136	136	136	130	130	156	220
G	6.5	6.5	6.5	6.5	6.5	6.5	6.5	6.5	6.5	15 x 6.5	15 x 6.5	16 x 9	16 x 9
H	1	1	1	1	1	1	1	1	1	1	1	4	4
I	17	17	17	25	25	25	39	25	39	39	45	85	110
J	M6	M6	M6	M6	M6	M6	M6	M6	M6	M10	M10	M10	M10
K	13	19.25	19.25	19.25	19.25	19.25	18.75	19.25	18.75	40	40	25	30
L	17	17	17	18.4	18.4	18.4	17	18.4	17	70	70	85	100

All dimensions in mm; 1 inch = 25.4mm
Tolerances according: ISO 2768-m / EN 22768-m

Filter input/output connector cross sections

	-29	-33	-34	-35	-36	-37
Solid wire	6mm ²	16mm ²	35mm ²	50mm ²	95mm ²	150mm ²
Flex wire	4mm ²	10mm ²	25mm ²	50mm ²	95mm ²	150mm ²
AWG type wire	AWG 10	AWG 6	AWG 2	AWG 1/0	AWG 4/0	AWG 6/0
Recommended torque	0.6 - 0.8Nm	1.5 - 1.8Nm	4.0 - 4.5Nm	7 - 8Nm	17 - 20Nm	27 - 30Nm

Please visit www.schaffner.com to find more details on filter connectors.

**Headquarters and
global innovation and
development center**

Schaffner Group
Nordstrasse 11
4542 Luterbach
Switzerland
T +41 32 681 66 26
F +41 32 681 66 30
info@schaffner.ch
www.schaffner.com

Sales and application centers

China
Schaffner EMC Ltd. Shanghai
Building 11, Lane 1365
East Kangqiao Road
Shanghai 201319
T +86 21 6813 9855
F +86 21 6813 9811
cschina@schaffner.com
www.schaffner.com

Germany
Schaffner Deutschland GmbH
Schoemperlenstrasse 12B
76185 Karlsruhe
T +49 721 56910
F +49 721 569110
germanysales@schaffner.com

Finland
Schaffner Oy
Tynninkuja 7
08700 Lohja
T +358 19 35 72 71
F +358 19 32 66 10
finlandsales@schaffner.com

France
Schaffner EMC S.A.S.
112, Quai de Bezons
95103 Argenteuil
T +33 1 34 34 30 60
F +33 1 39 47 02 28
francesales@schaffner.com

Italy
Schaffner EMC S.r.l.
Via Galileo Galilei, 47
20092 Cinisello Balsamo (MI)
T +39 02 66 04 30 45/47
F +39 02 61 23 943
italysales@schaffner.com

Japan
Schaffner EMC K.K.
Mitsui-Seimei Sangenjaya Bldg. 7F
1-32-12, Kamiyama, Setagaya-ku
Tokyo 154-0011
T +81 3 5712 3650
F +81 3 5712 3651
japansales@schaffner.com
www.schaffner.jp

Sweden
Schaffner EMC AB
Turebergstorg 1, 6
19147 Sollentuna
T +46 8 5792 1121/22
F +46 8 92 96 90
swedensales@schaffner.com

Switzerland
Schaffner EMV AG
Nordstrasse 11
4542 Luterbach
T +41 32 681 66 26
F +41 32 681 66 41
sales@schaffner.ch

Singapore
Schaffner EMC Pte Ltd.
Blk 3015A Ubi Road 1
05-09 Kampong Ubi Industrial
Estate
T +65 6377 3283
F +65 6377 3281
singaporesales@schaffner.com

Spain
Schaffner EMC España
Calle Caléndula 93,
Miniparc III, Edificio E
El Soto de la Moraleja,
Alcobendas
28109 Madrid
T +34 618 176 133
spainsales@schaffner.com

Taiwan
Schaffner EMV Ltd.
6th Floor, No 413
Rui Guang Road
Neihu District
Taipei City 114
T +886 2 87525050
F +886 2 87518086
taiwansales@schaffner.com

Thailand
Schaffner EMC Co. Ltd.
Northern Region Industrial Estate
67 Moo 4 Tambon Ban Klang
Amphur Muang P.O. Box 14
Lamphun 51000
T +66 53 58 11 04
F +66 53 58 10 19
thailandsales@schaffner.com

UK
Schaffner Ltd.
5 Ashville Way
Molly Millars Lane
Wokingham
Berkshire RG41 2PL
T +44 118 9770070
F +44 118 9792969
uksales@schaffner.com
www.schaffner.uk.com

USA
Schaffner EMC Inc.
52 Mayfield Avenue
Edison, New Jersey 08837
T +1 732 225 9533
F +1 732 225 4789
usasales@schaffner.com
www.schaffner.com/us

To find your local partner within
Schaffner's global network, please go to

www.schaffner.com

May 2011

© 2011 Schaffner EMC.
Specifications subject to change without
notice. All trademarks recognized.

Schaffner is an ISO-registered company.
Its products are designed and manufac-
tured under the strict quality and environ-
mental requirements of the ISO 9001 and
ISO 14001 standards.

This document has been carefully
checked. However, Schaffner does not
assume any liability for errors or inac-
curacies.