

PSZ-1010

EMV-Filter für Print-Montage

EMC filter for print mounting

Technische Daten / Technical data

Eingangsspannung / input voltage	85...264 V
Nominalstrom / Nominal current	max. 0,5 A
Dämpfung / attenuation	ca. 20 dB
Betriebstemp. / Operating temp.	-30...+80 °C
Lagertemp. / Storage temp.	-50...+120 °C
Gewicht (netto) / Weight (net)	0,05 kg
Gehäusematerial / Chassis material	Plastik / Plastics (UL94-V0)



Gehäuse-Zeichnung PSZ-1010 / Drawing PSZ-1010

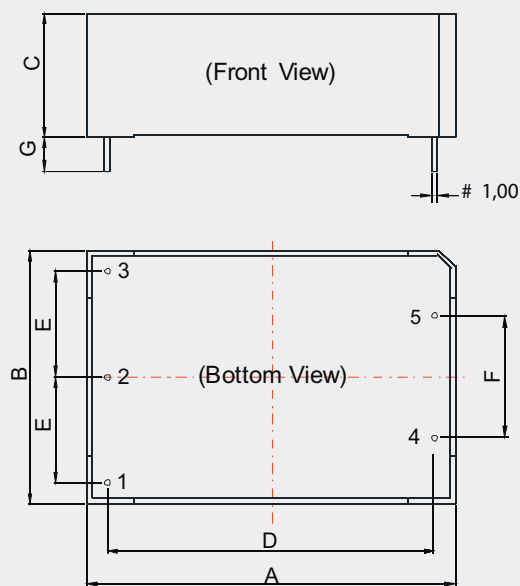

Pin diameter tolerances: $\pm 0,10$ mm
 General tolerances: $\pm 0,50$ mm

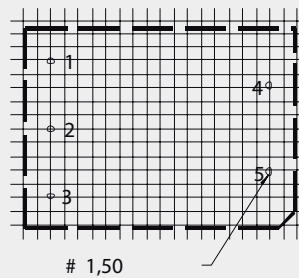

Note: Grid 2,54 x 2,54 mm

PIN-Belegung / Pin assignment

1	GND
2	IN (N)
3	IN (L)
4	OUT (N)
5	OUT (L)

Abmessungen / Dimensions

A	48,50 mm
B	36,00 mm
C	20,50 mm
D	40,50 mm
E	12,50 mm
F	16,00 mm
G	6,00 mm